

Motorised Sieve Shaker
200mm/300mm - 8/12 inch
SV003

Impact Test Equipment Ltd
www.impact-test.co.uk & www.impact-test.com

User Guide
User Guide
User Guide

**Impact Test Equipment Ltd.
Building 21 Stevenston Ind. Est.
Stevenston
Ayrshire
KA20 3LR**

T: 01294 602626

F: 01294 461168

E: sales@impact-test.co.uk

Test Equipment Web Site

www.impact-test.co.uk

Test Sieves & Accessories Web Site

www.impact-test.com

Sieve Shaker
200mm/300mm - 8/12 inch
SV003

CONTENTS

Introduction

Specification

Installation

Controls

Operation

Maintenance

Spares and Accessories

Parts Diagram

Vibration Adjustment

1 Introduction

The unique action of this Sieve Shaker (Fig 1) imparts a circular motion to the material being sieved so that it makes a slow progression over the surface of the sieve. A rapid vertical movement simultaneously agitates the sample, assisting in clearing the apertures. A time switch is incorporated for tests of varying duration.



2 Specification

Dimensions	Length	Width	Height
	525 mm	510 mm	1085 mm
Weight	78 kg		
Capacity			
200mm or 8 inch diameter sieves	Up to twelve plus lid and receiver		
300mm or 12 inch diameter sieves	Up to six plus lid and receiver		

3 Installation

WARNING: This product weighs 78 kg and care must be taken when lifting. Do not attempt to lift it with only one person. Use sufficient resources to lift it safely in order to avoid injury.

3.1 Assembly (Fig 2)

- 3.1.1 Screw the hexagon nut as far as possible onto each of the two clamping rods followed by a plain washer. Screw the rods fully into the location plate and tighten the nuts.
-

-
- 3.2 Position the shaker on a suitably level, rigid and robust surface (placing the machine on a level surface ensures the even distribution of the sample over the sieves).

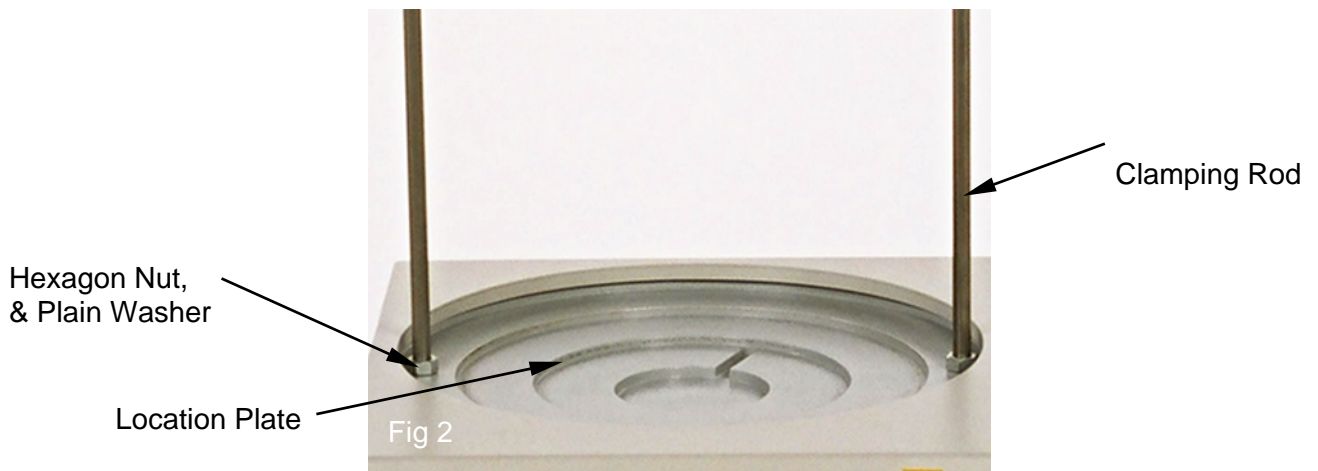

Safety

Whilst the shaker is in operation do not remove any covers or attempt to adjust any part of the machine.

Ensure all moving parts are thoroughly secured before attempting any maintenance.

Ensure all appropriate measures are taken to protect the operator from excessive noise.

See noise certificate (when supplied).

Power Supply

Electrical safety

Warning: Before removing any covers or performing maintenance repair and service, isolate from electrical supply by removing mains plug. Where mains supply is required during these activities, only competent persons should perform the work.

Check that the power supply is compatible with the requirements stated on the label and connect in accordance with IEE regulations or to local requirements.

This machine may be operated through a standard 13 amp socket outlet when fitted with an appropriate 3 pin plug fused in accordance with the label.

The power cable is coded as follows:

Brown wire	L	Live or Power
Blue wire	N	Neutral
Green/Yellow wire	E	Earth or Ground

Important: this equipment must be correctly earthed.

Note: Do not use the machine with wet hands. Dry hands before operating machine.

Portable Appliance Tests (PAT)

An electrical safety test label is fitted (usually adjacent to the mains input socket).

Organisations have an obligation to ensure equipment is maintained and is safe for use. Regular PAT testing is one means of ensuring equipment continues to be electrically safe.

Important: do not connect PAT leads to sensitive components such as PCBs, control switches and the like.

DO NOT FLASH TEST ELECTRONIC EQUIPMENT.

If in doubt as to the most suitable connection point (which will usually be an earth stud or an external earth connection) contact Impact for assistance.

4 Controls

4.1 Rear panel (not shown)

4.1.1 Power inlet and 5A fuse.

4.1.2 Thermal trip, push to reset.

4.1.3 Mains On / Off switch, machine will only run with this in the On position.

4.2 Front panel (Fig 4)

4.2.1 Mains Indicator light (Green), illuminates when mains switch is On and machine is ready to run.

4.2.2 Timer 10 – 60 minutes, turn clockwise to set duration of test, this also starts the machine providing that the mains switch is On. At the end of the set time the shaker stops automatically.



5 Operation

5.1 Sieve Stacking (Fig 5)

Place the receiver centrally into the appropriate recess in the location plate. Stack the required number of sieves on top of the receiver. Place the sample in the top sieve and fit the lid.

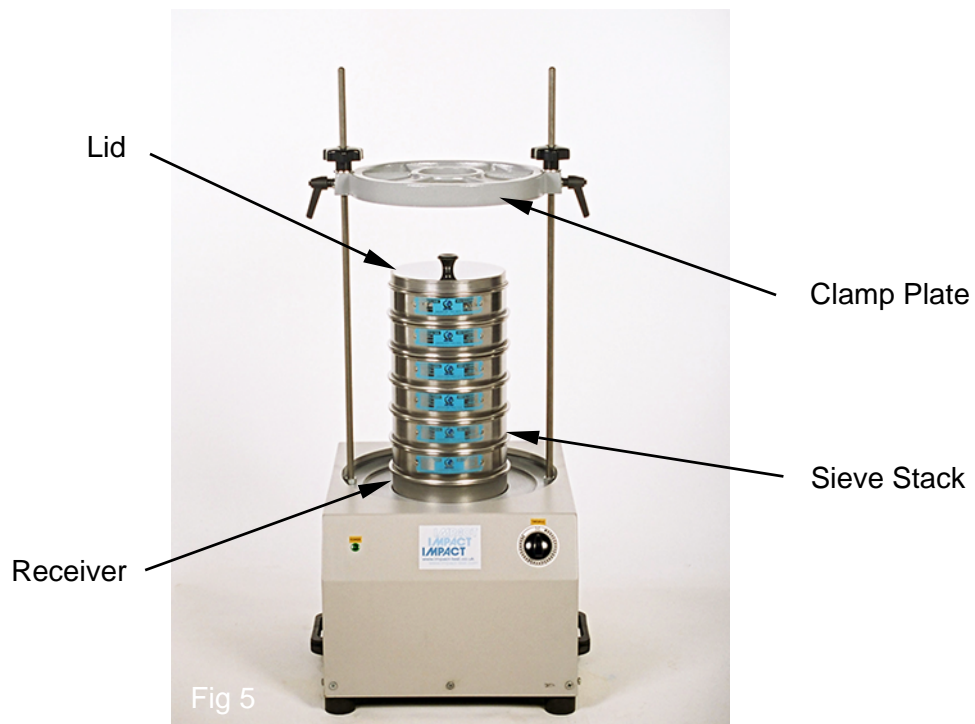

5.2 Fitting the Clamp Plate (Figs 5 and 6)

Locate the clamp plate onto the two rods and slide down squarely onto the lid of the sieve stack.

Unscrew the handwheels until there is approximately a gap of 5mm between the lower face of the handwheel and the washer, apply downward pressure to the clamp plate and tighten the locking levers. The levers should be positioned pointing downwards, they may be repositioned by pulling outwards and rotating to the correct position.

Fully tighten the handwheels simultaneously to ensure that the clamp plate is square.

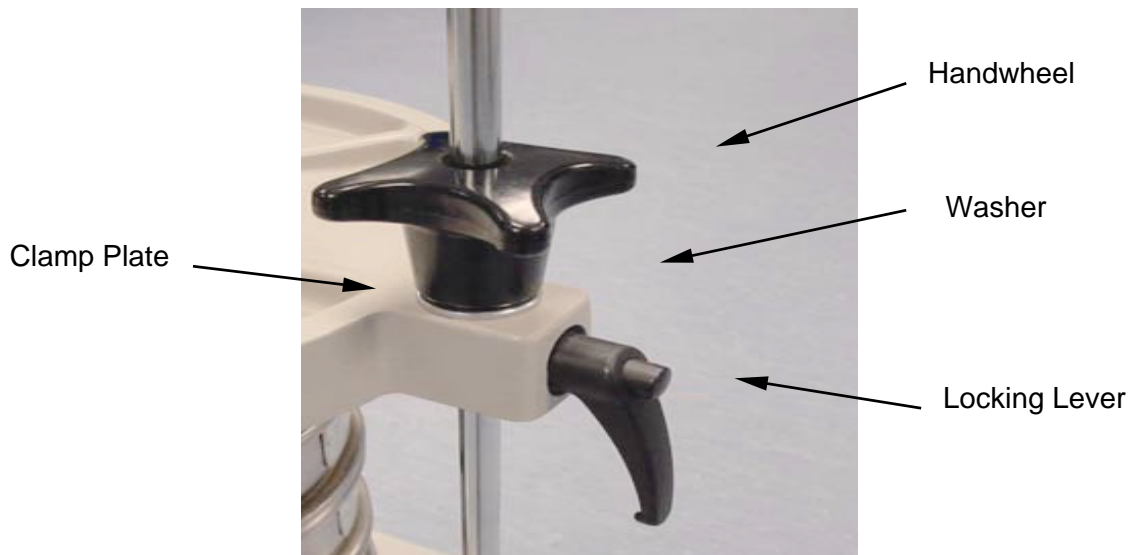

5.3 Running the test

Ensure the mains switch is on (red warning light illuminated).

Start the machine by turning the timer knob clockwise to the desired duration of the test.

The machine may be stopped at any time during operation by turning the timer knob fully anti-clockwise to the zero position.

At the end of the test the clamp plate and sieve stack may be removed in the reverse order to which they were assembled.

6 Maintenance

6.1 The Sieve Shaker is maintenance free other than keeping it clean and free from debris, especially with regard to the recesses in the location plate. The external surfaces may be cleaned using a mild detergent solution, under no circumstances should solvents be used.

6.2 Periodically lightly oil the clamping mechanisms and rods.

7 Spares and Accessories

7.1 For spares and accessories please contact Impact

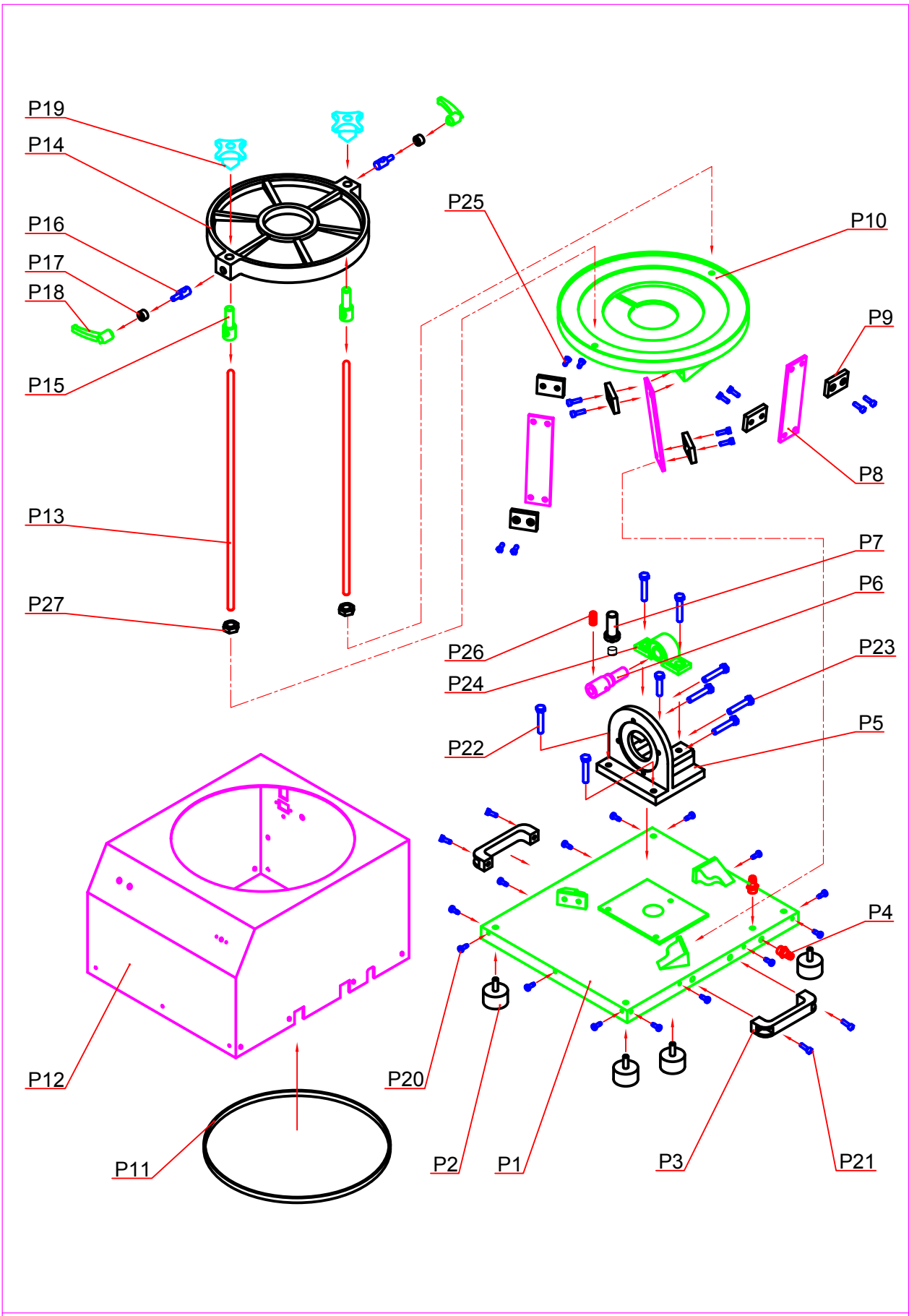

SV003 Motorised Sieve Shaker

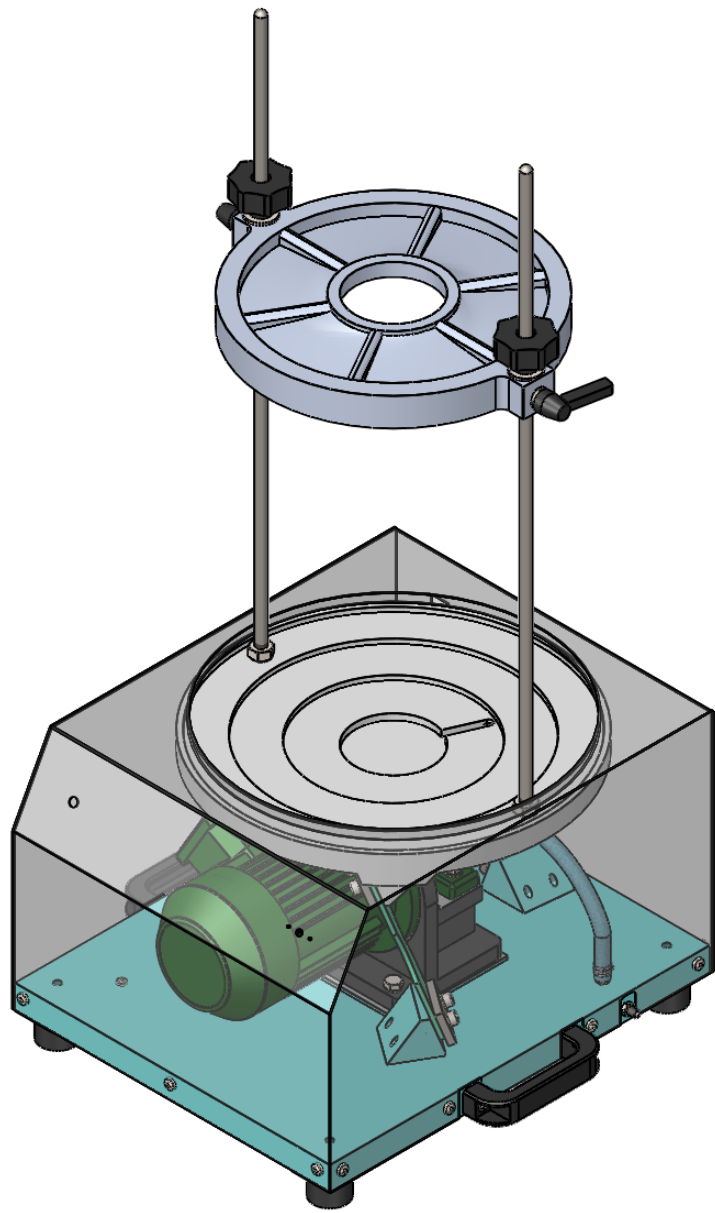

Vibration Adjustment

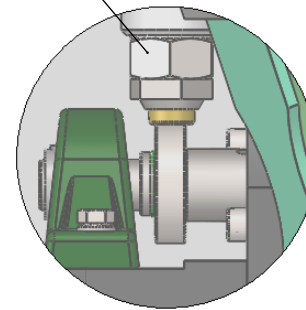

DETAIL A
SCALE 1 : 3

